



tooling for punch presses

THICK TURRET

INDEX

●	COMPANY PROFILE	2
●	OUR PRODUCTS	3
●	WHAT'S NEW	4
●	JETFORM	6
	COMMON FORMING	8
	SPECIAL FORMING	9
	CONTINUOUS FORMING	10
●	CLUSTER TOOL	11
●	MULTIMATRIX	12
●	GREEN SERIES	
	A STATION	16
	B STATION	17
	C STATION	18
	D STATION	19
	E STATION	20
●	WHITE SERIES	
	A STATION	22
	B STATION	24
	C STATION	26
	D STATION	27
	E STATION	28
	F STATION	29
●	RED SERIES	
	A STATION	30
	B STATION	31
	C STATION	32
	D STATION	33
	E STATION	34
	F STATION	35
●	ACCESSORIES	
	STANDARD ADAPTORS	38
	PARTING TOOLS	39
	PARTING TOOLS CLOSE TO CLAMP	40
	TRUMPF® ADAPTORS	42
	MURATA WIEDEMANN® ADAPTORS	43
	SPECIAL SPRINGS SETS	44
	CENTERING TOOLS	45
	OPTIONS	46
	LUBRIFICATION - GRINDING	48
●	JETFORM	
	JETFORM GREEN SERIES	50
	JETFORM WHITE SERIES	52
●	MATRIX SHAPE CODING	54
●	OPTION LEGEND	55
●	GUIDE TO PRODUCT CODES - MATRIX CODING	55

COMPANY PROFILE

A dynamic team

Matrix' products, the result of our highly qualified technicians' competence which constantly deal with problems connected to production cycles as well as specific customer's requirements.

The customer, a unique partner

Each customer deserves special care, that's why Matrix doesn't simply offer a product but also a specialized consulting service and technical support, in order to reach the high competitive level required by the market.

Punches and dies born to last

The high reliability and life lasting which characterize Matrix' products, are the result of experience, devotion, constant research and use of superior quality raw materials.

Innovative technologies for high performances

Matrix invests on the best technologies: from designing software to the most modern planning techniques, from cutting edge machineries to sophisticated control systems.

Energies oriented to the maximum accuracy

The constant investments in machineries for our production is a must in order to keep the elevate standard level required by processing.

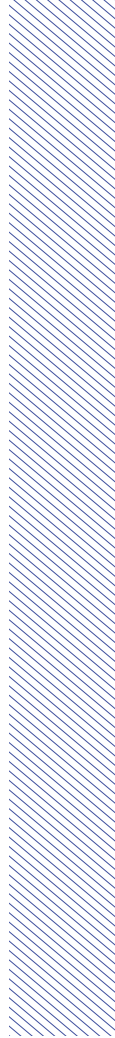
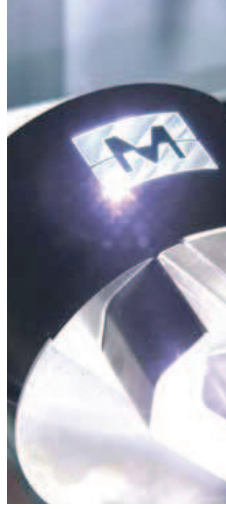

OUR PRODUCTS

Punches

Manufactured in accordance with the most modern techniques and machineries, produced with a unique type of steel (M2), hardened with the first quality heat treatments.



Strippers or sliding guides

Manufactured with steels either resistant to wearing or heavy stress, produced with proper tolerances to guarantee endurance to punches and punching machine turret. All guides are hardened and whenever possible, supplied with proper lubricating grooves.



Dies

Full automatic production and control cycles guarantee to our dies a maximum level standard quality. Manufactured with high performing steels (D2) and hardened with equal value treatments for the best structural tension and endurance, we pay great attention to the dies geometry.



Special tools

The constant demand of special tools specific for particular processing, requires alternative and innovative solutions and reduced delivery times. Each special tool is coded for its reproduction and controlled on all production phases, from designing to testing.



WHAT'S NEW?

New series Green, White and Red offer a great compatibility level with different types of tools already on the market, getting advantageous solutions for each punching requirement.

New series of Murata-Wiedemann® adaptors for the use of tools of this known brand on thick turret machines, continuing to improve solutions dedicated to Trumpf® tools.

All this, together with the high and well known quality which has been always characterizing Matrix' products. For any tools model, or lubricating or end scrap evacuation system, our products can satisfy any requirement as far as quality, performing and innovation.



WHITE SERIES

The most compatible series of Matrix' range

The recent introduction of punch holders for tools W90 LINE and F station, make of WHITE Series the suitable solution to replace any other similar product available on the market, granting very high performances.

Like for GREEN Series, perfect compatibility with the most common type of tools for a thick turret either for original long type, with or without lubrication, or different models lubricated short.

The stroke adjusting by mean of push button, is now available also on A and B stations, getting more and more performing.



GREEN SERIES

Green series punch holders represent the best of Matrix' offer

Characterized by a quick adjusting and technical solutions for a better and longer tool life.

Perfectly compatible, they perform with the most common thick turret tools available on the market, either long original style, with or without lubrication, or various short and lubricated models.

Continuous tools stroke adjusting and quick stripper replacement, keyless.



RED SERIES

Economical and efficient series

Totally compatible with long original style turret tools, with or without lubrication, punch holders RED Series are the right choice for heavy working.

Besides the holders with integrated strippers, the solution with interchangeable strippers is also available on A and B station, already appreciated on other Matrix' series.

New adjustable springs sets are available to double tools life and to adjust the height properly.

F station punch holders available also on RED Series.





JETFORM

Jetform, line of tools for sheet metal forming, for **efficient machine performances**. Processings available from extrusions to engravings, clips and embosses and many others.

JETFORM inserts holder line is available on B, C, D and E station, with interchangeable inserts to reduce the costs for a new forming.

To better adapt to the specific customer's needs, Matrix' offer includes two types of inserts holders.

The Green Series characterized by an **accurate step adjusting of tool height**; the best choice for punching machines with imprecise or missing stroke adjusting.

The White series, **without adjusting**, exploits the stroke adjusting of the most recent punching machines.

All inserts holders are manufactured with a **total components lubrication system**; this works by getting a specific oil from the top, either automatically or manually.

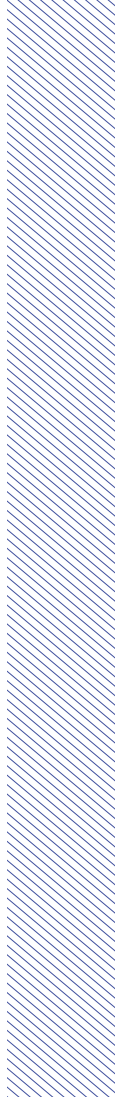

COMMON FORMING - JETFORM

The most common forming are embosses, countersinks, engravings, logos, louvers and many others. The great diffusion of these forming allows to handle a wide offer of standardized products, reducing drastically delivery times. This type of forming is continuously growing, so please contact our sales department for assistance.



M01
ENGRAVED COUNTERSINK
FORMING



M02
EXTRUDED HOLE
FORMING

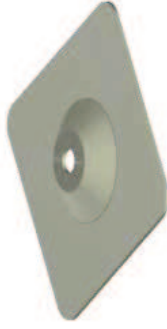

M03
ROUND EMBOSS
FORMING



M04
ROUND COUNTERSINK
FORMING



M09
SHELF CLIP
FORMING



M12
RADIUS BACK LOUVER
FORMING



M13
SHEAR BUTTON
FORMING



M14
ENGRAVING
FORMING



M23
DOT SCRIBER
ENGRAVING

SPECIAL FORMING - JETFORM

Our technical department is available to develop the best solutions for our customer's requirements. Thanks to this versatility we have no limits to satisfy the most complex requirements. The constant research of new solutions extends the possibility on the forming field, adding to normal engraving also tridimensional images.



**M24 - STRENGTHENED CLIP UP
WITH SAFETY BUTTON**
FORMING



M25
STRENGTHENED SPECIAL CLIP UP
FORMING



M10
MULTIPLE KNOCKOUT
FORMING



M22
CUSTOM LOGO
RELIEF



M26
EMBOSS FOR ELECTRICAL CABLES
FORMING



M27
BRIDGED & EXTRUDED HOLE DOWN
FORMING



M28
BENDING TOOL
FORMING

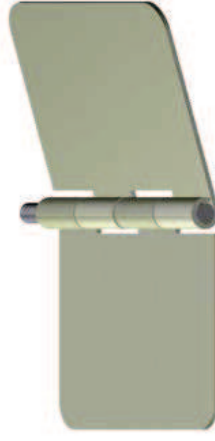

M29
HINGE
FORMING

CONTINUOUS FORMING AND SPECIAL APPLICATIONS - JETFORM

The most recent technical solutions implemented on the modern punching machines for much better tools control than in the past, gives great impulse to new applications. New special tools have been developed to shear the protecting film laid on the sheet metal or continuous embosses or to deburr sheared parts.

These are only some examples of what you could get from your punching machine just using Matrix products.



M15
CONTINUOUS RADIUS BACK LOUVER
SHEARING & FORMING



M20
CONTINUOUS OBROUND EMBOSS
FORMING



M30
SCRIBER
ENGRAVING



M31
DEBURR
ENGRAVING



M32
FOIL SLITTING TOOL
ENGRAVING

CLUSTER TOOL

Punching of cluster holes is easier with cluster tools which grants great accuracy of final result. This particular type of tools can be manufactured either as integral tool or with interchangeable inserts for a considerable saving already on the medium use.

As for all our specials, our cluster tools – round and shaped – are followed up to testing by mean of coding and electronic filing of all particulars, for a quick and precise availability.

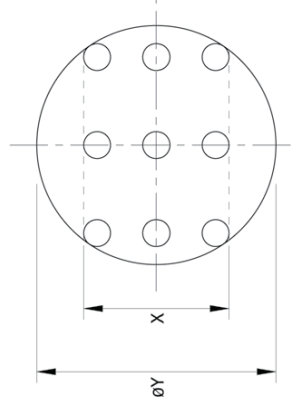

	B Station	C Station	D Station	E Station
X	21	21	56	71
øY	31,7	50,8	88,9	114,3

TOOLING FOR MULTITOOLO - MULTIMATRIX



MULTIMATRIX



MULTIMATRIX LINE

Tool with the **best axial stability** on the market, directly from whom first have introduced long guided tools on thick turret Multitool.

Multimt LINE

Tools for the most common multitool on the market, manufactured with our **high qualitative standard** of all Matrix products, and with an extremely quick delivery system.

ADJUSTING TOOL

This solution for thick turret Multitool, introduced from Matrix first in 2007, **triplicates tool life**.
On the new Multimatrix Series 6/24-AR and Multimt Series 6/24-6 AR, combined use of a universal head and punch with threaded extremity, allows **total height adjusting in few seconds, keyless**.

Innovation, maximum rigidity and less tool wear are the peculiar characteristics of our multitool

Available in several models:

- number of tools variable from 4 to 10;
- rotating and indexable;
- for mono head and turret punching machines.

	NUMBER OF TOOLS	MAX Ø SIZE	MAX WORKING LIMITS
MULTIMATRIX Serie 24-MMX	6	mm 24	max tonnage 15 tons
MULTIMATRIX Serie 10/18-MMX	10	mm 18	max tonnage 12 tons
MULTIMATRIX 4/B-MMX	4	mm 31,7	max tonnage 15 tons
MULTIMATRIX 6/24-6-ERHP	6	mm 24	max tonnage 15 tons
MULTIMATRIX 6/A	6	mm 12,7	vary according to the punch holder
MULTIMATRIX 2A/2B	2+2	mm 12,7 - mm 31,7	vary according to the punch holder





PUNCH HOLDERS AND TOOLS



Tools codes indicated in our catalogues refer to the corresponding shape and can vary accordingly.

GREEN SERIES - A STATION - MAX Ø = mm 12,7

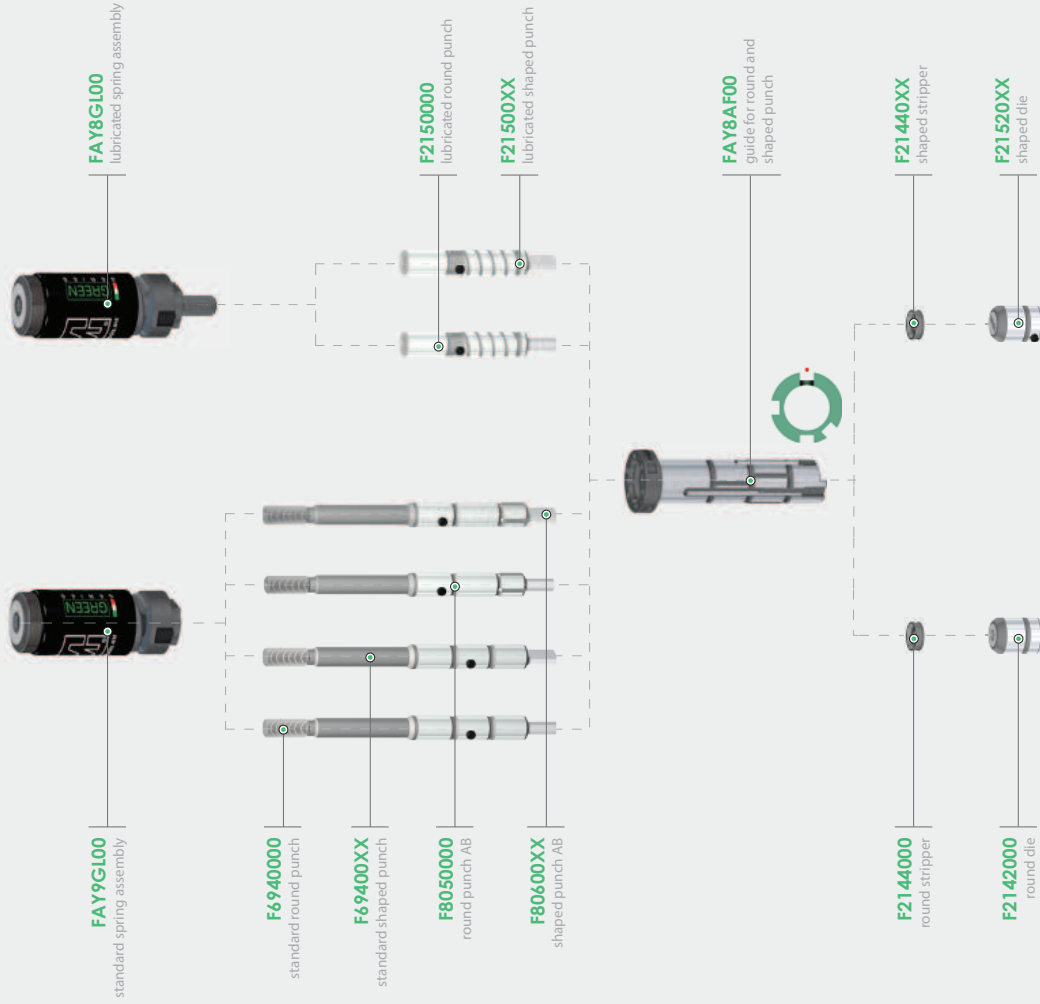

OPTIONS AND NOTES



GREEN SERIES - B STATION - MAX Ø = mm 31,7

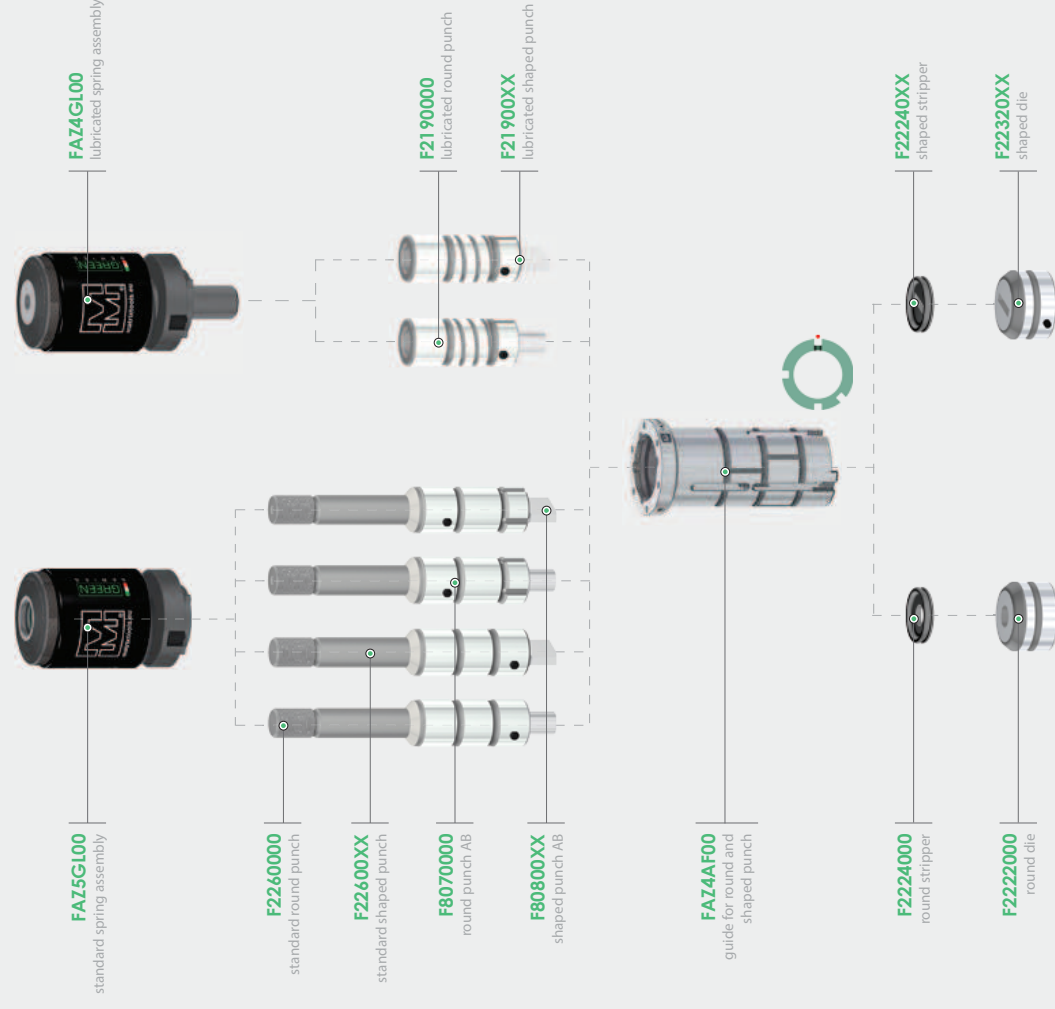

OPTIONS AND NOTES

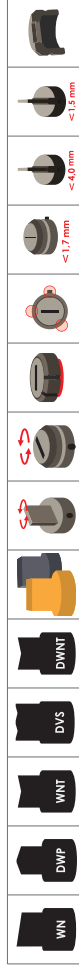

GREEN SERIES - C STATION - MAX Ø = mm 50,8

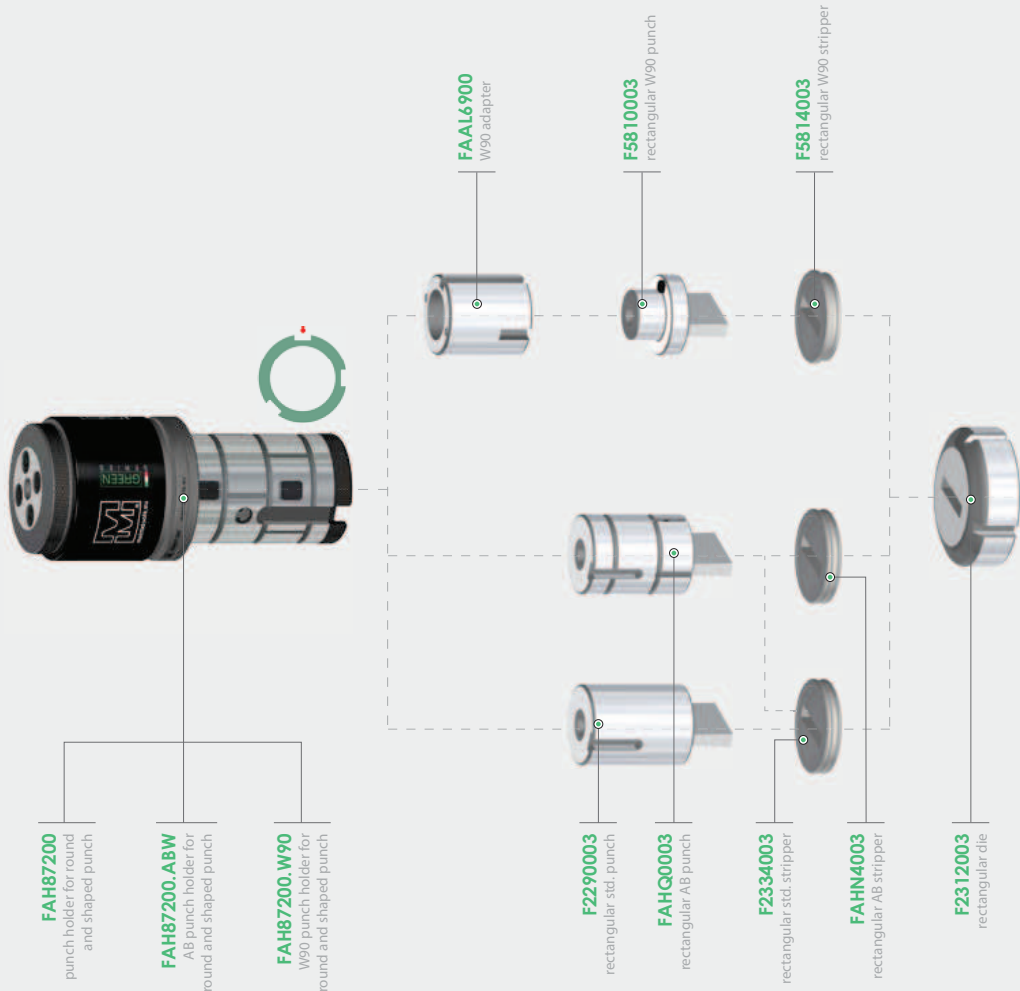

OPTIONS AND NOTES

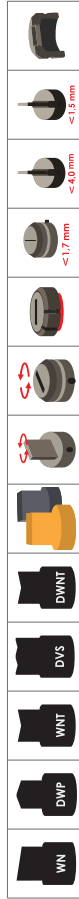

GREEN SERIES - D STATION - MAX Ø = mm 88,9

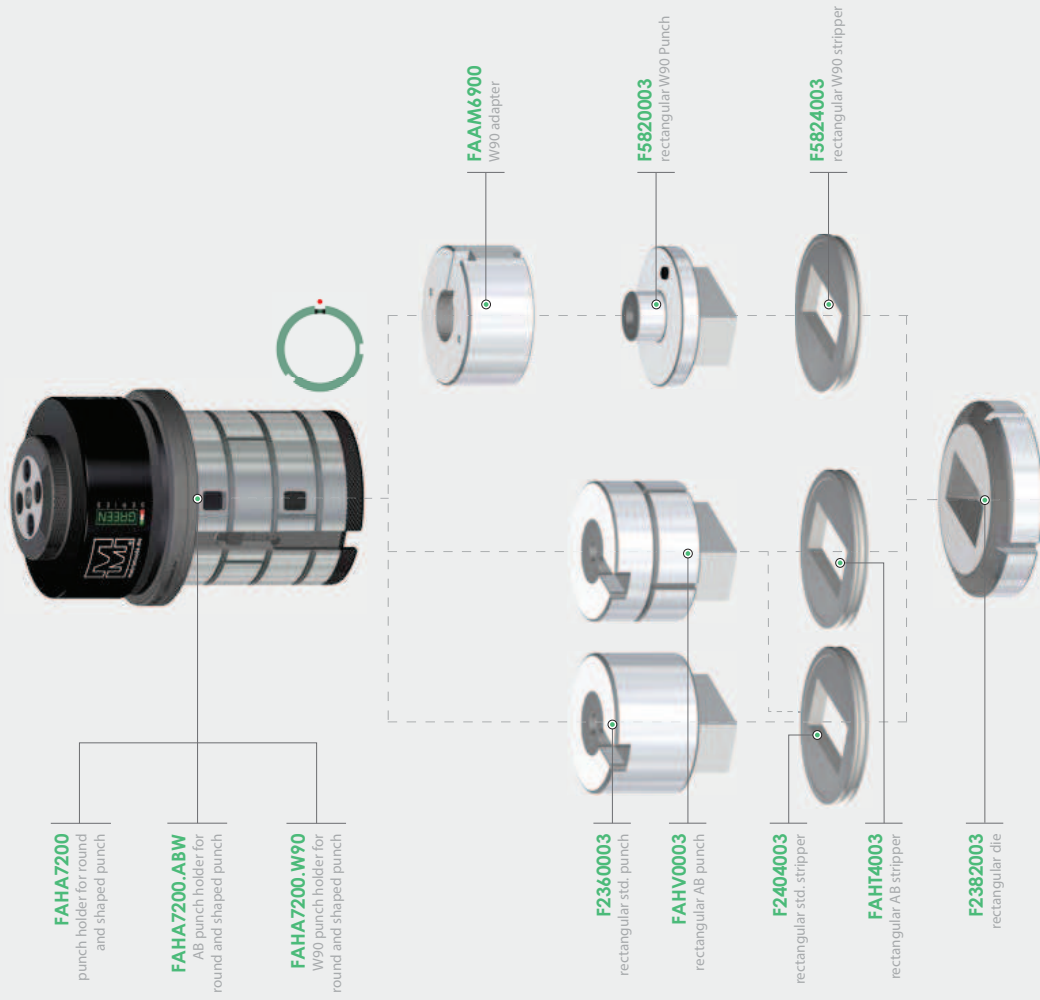

OPTIONS AND NOTES

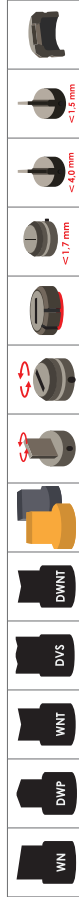

GREEN SERIES - E STATION - MAX Ø = mm 114,3

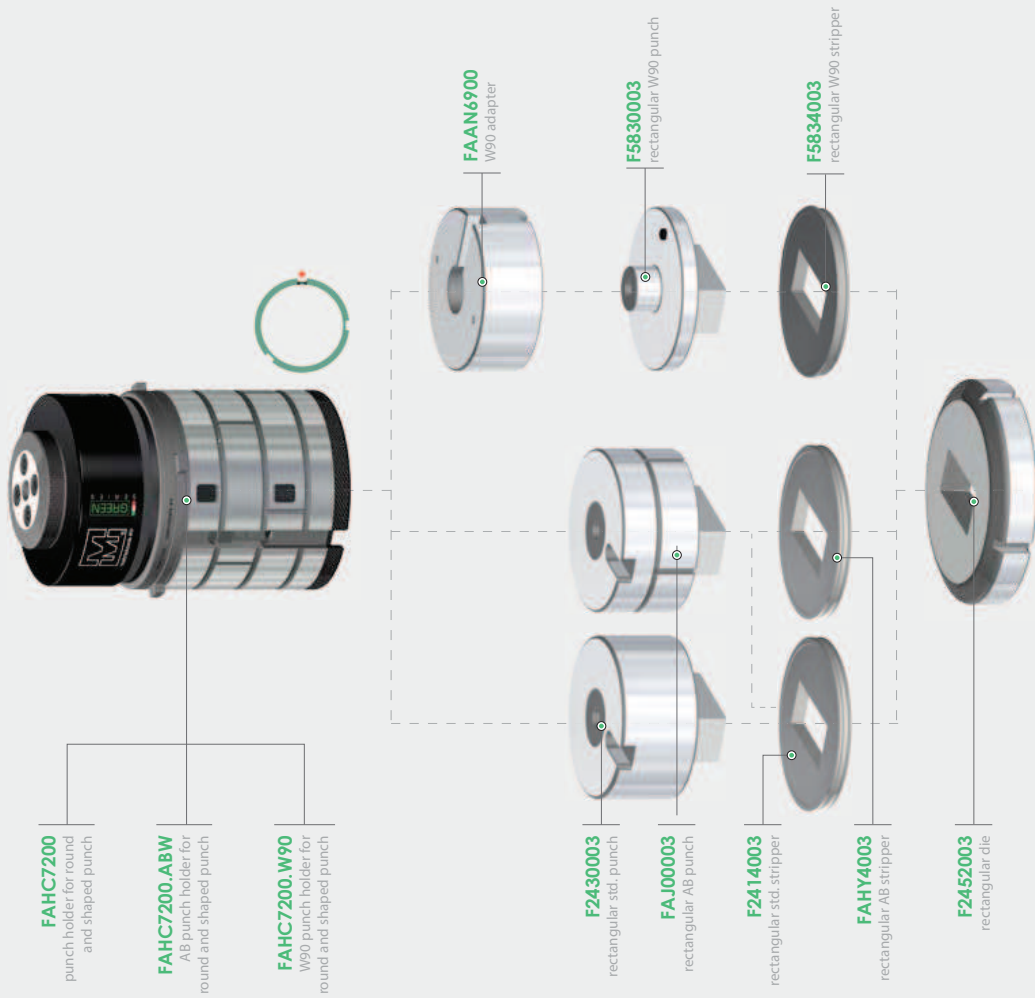

OPTIONS AND NOTES



WHITE SERIES - A STATION - MAX Ø = mm 12,7

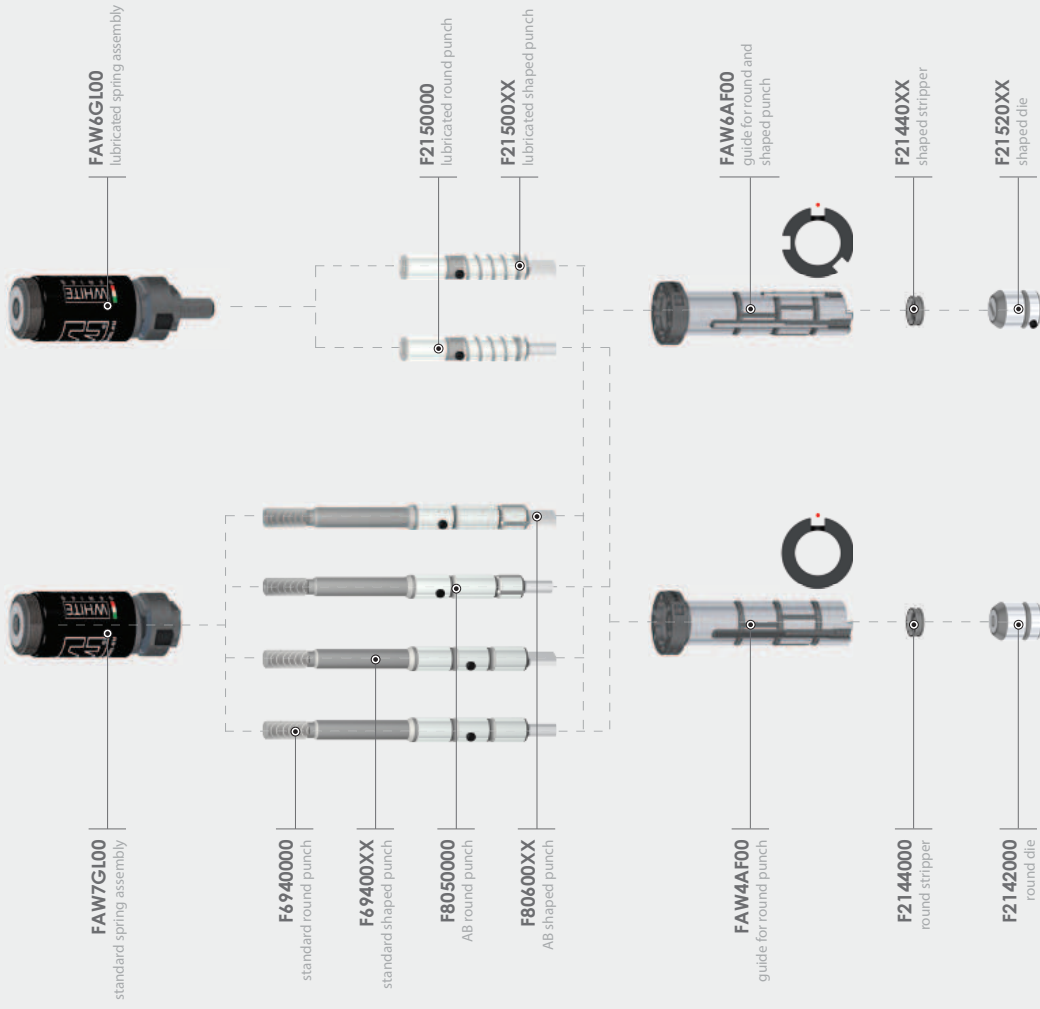

OPTIONS AND NOTES



WHITE SERIES - A STATION - W90 - MAX Ø = mm 12,7

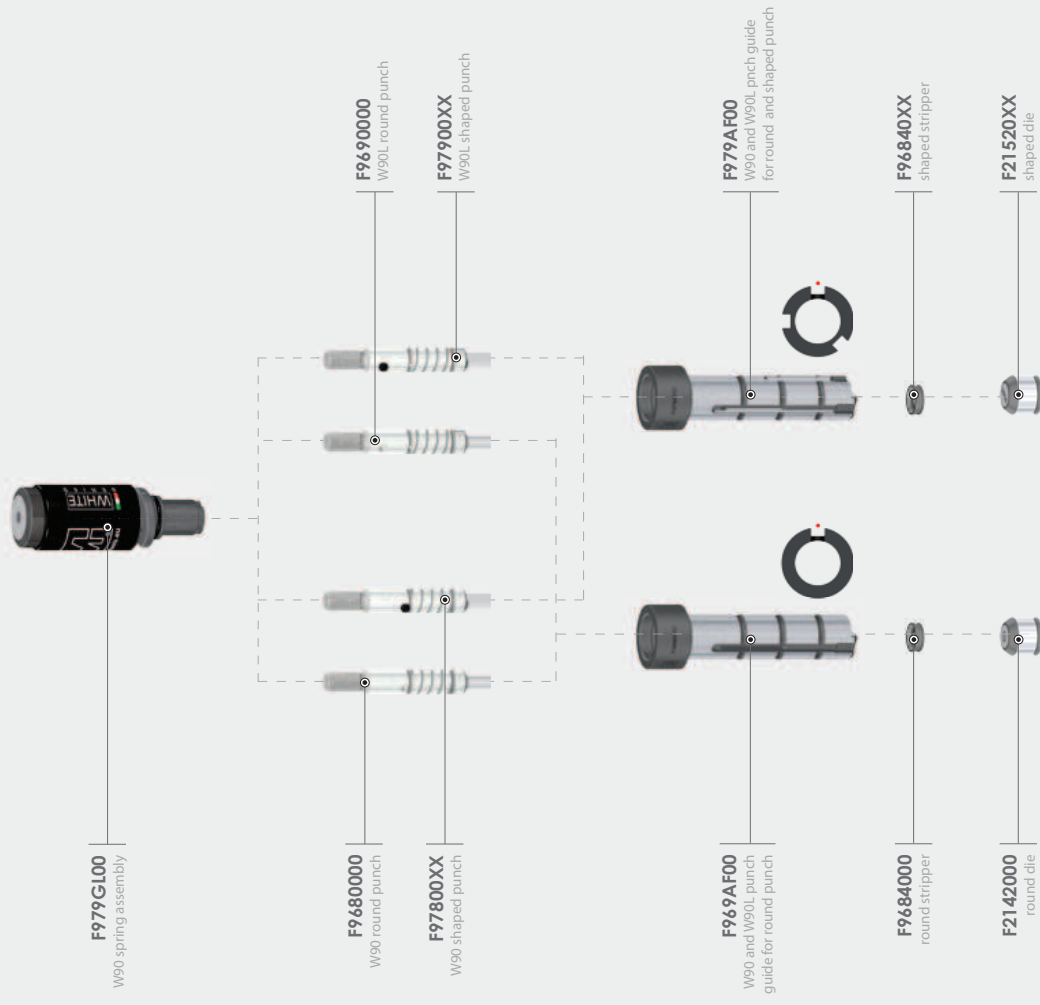

OPTIONS AND NOTES



WHITE SERIES - B STATION - W90 - MAX Ø = mm 31,7

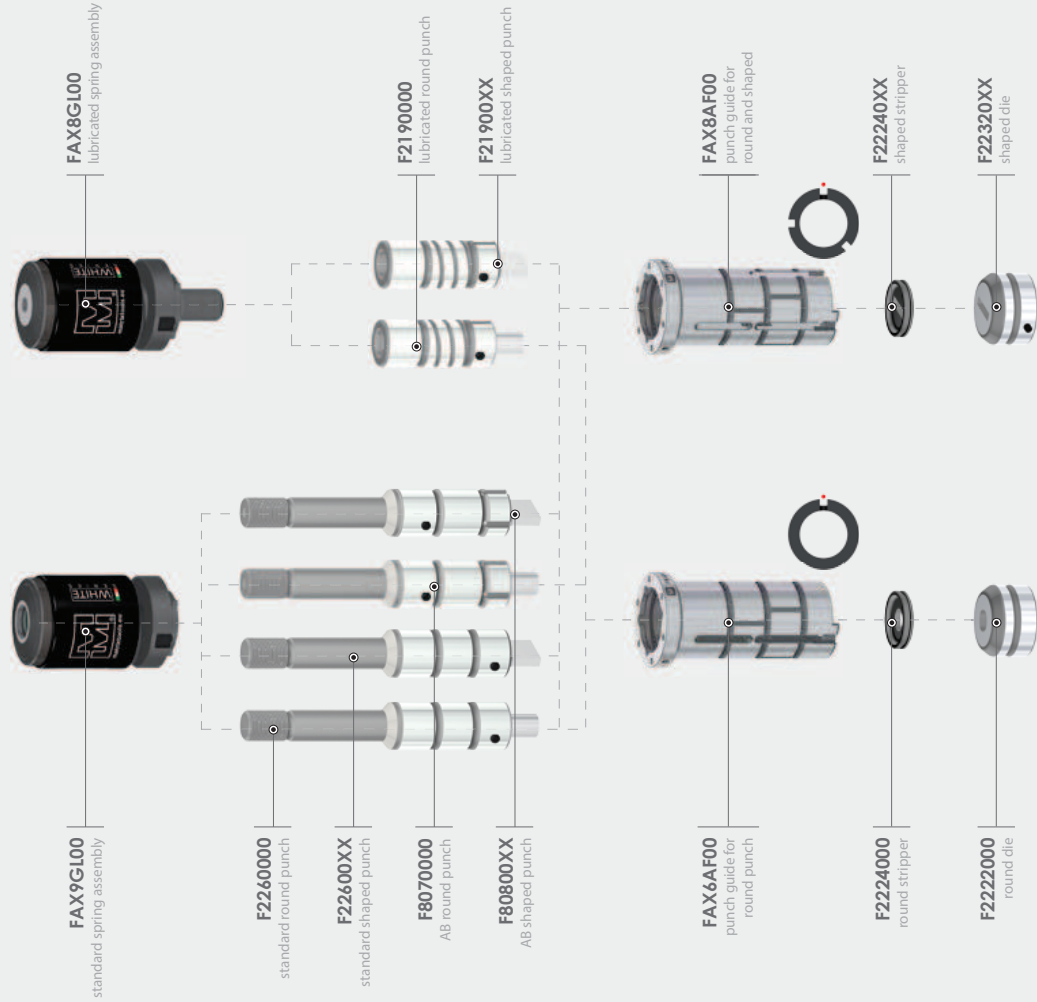

OPTIONS AND NOTES



WHITE SERIES - B STATION - W90L - MAX Ø = mm 31,7

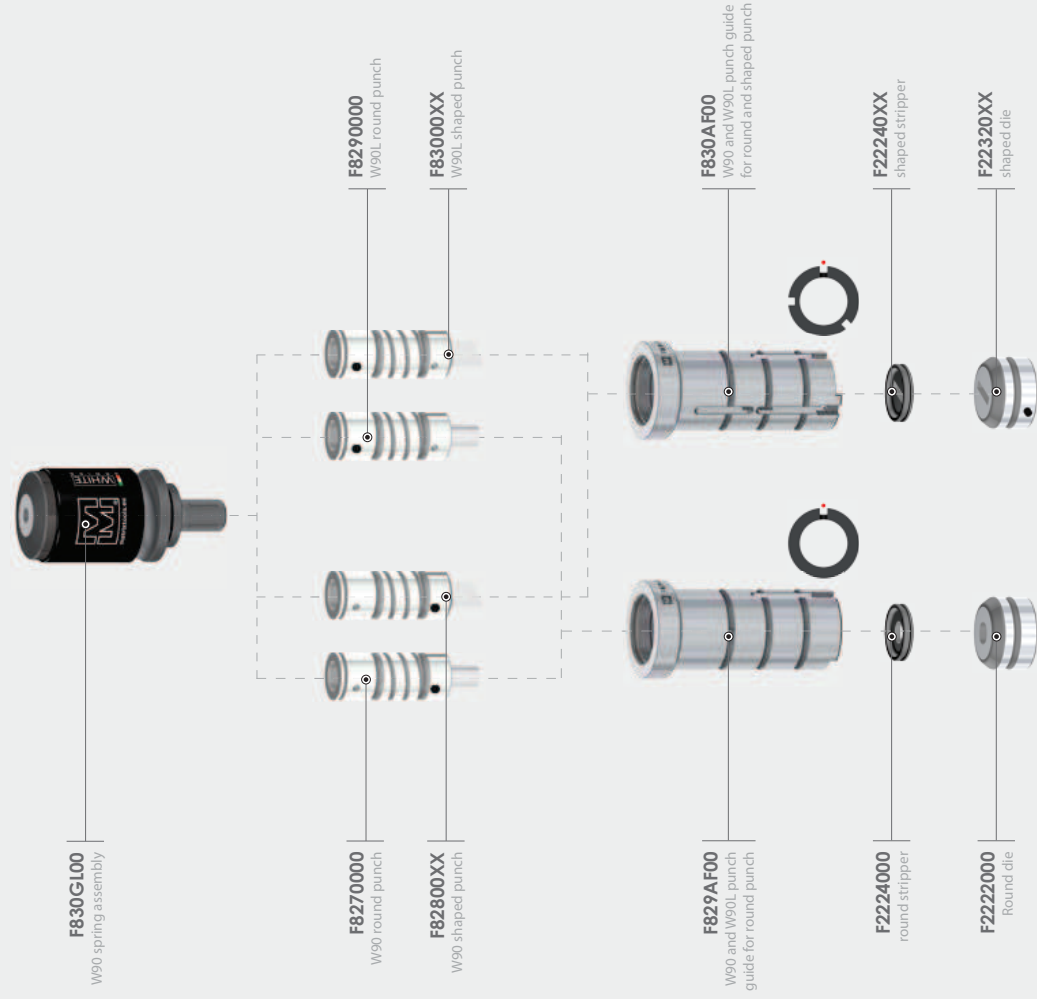

OPTIONS AND NOTES



WHITE SERIES - C STATION - MAX Ø = mm 50,8

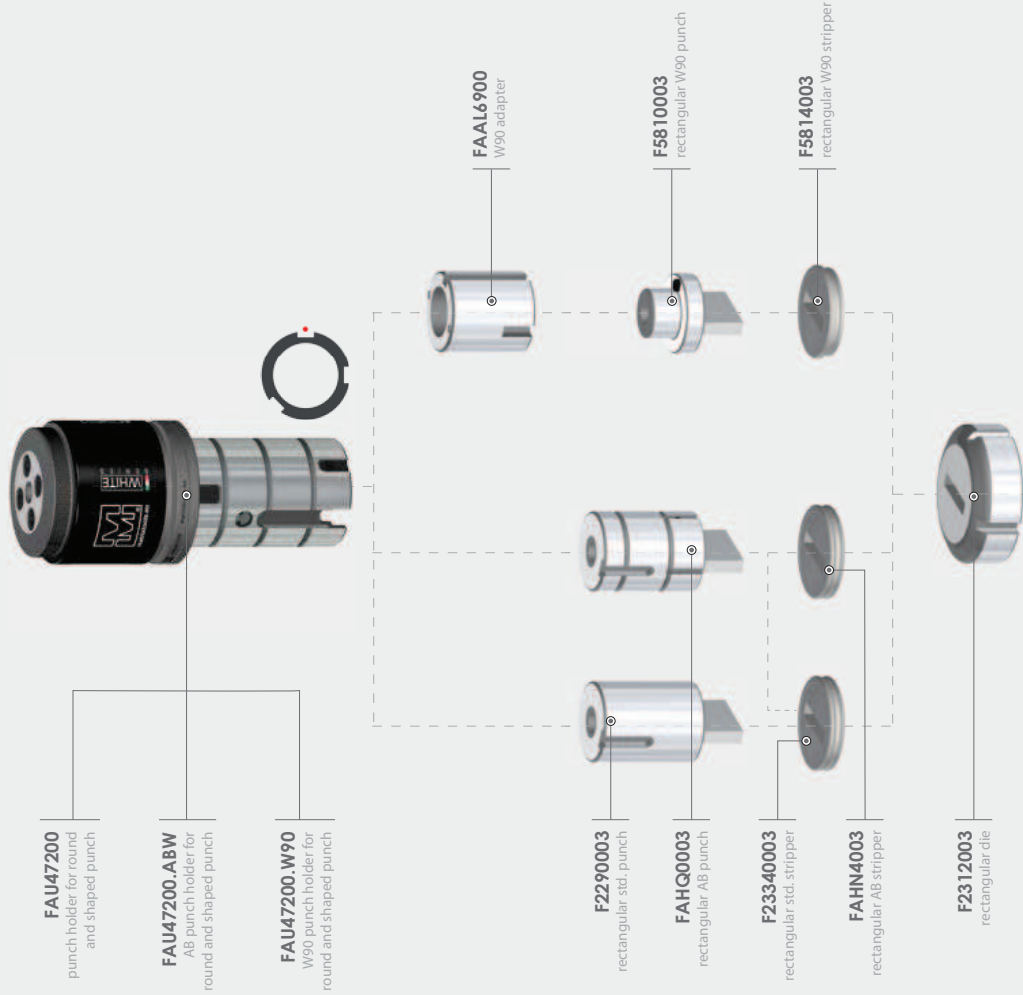

OPTIONS AND NOTES



WHITE SERIES - D STATION - MAX Ø = mm 88,9

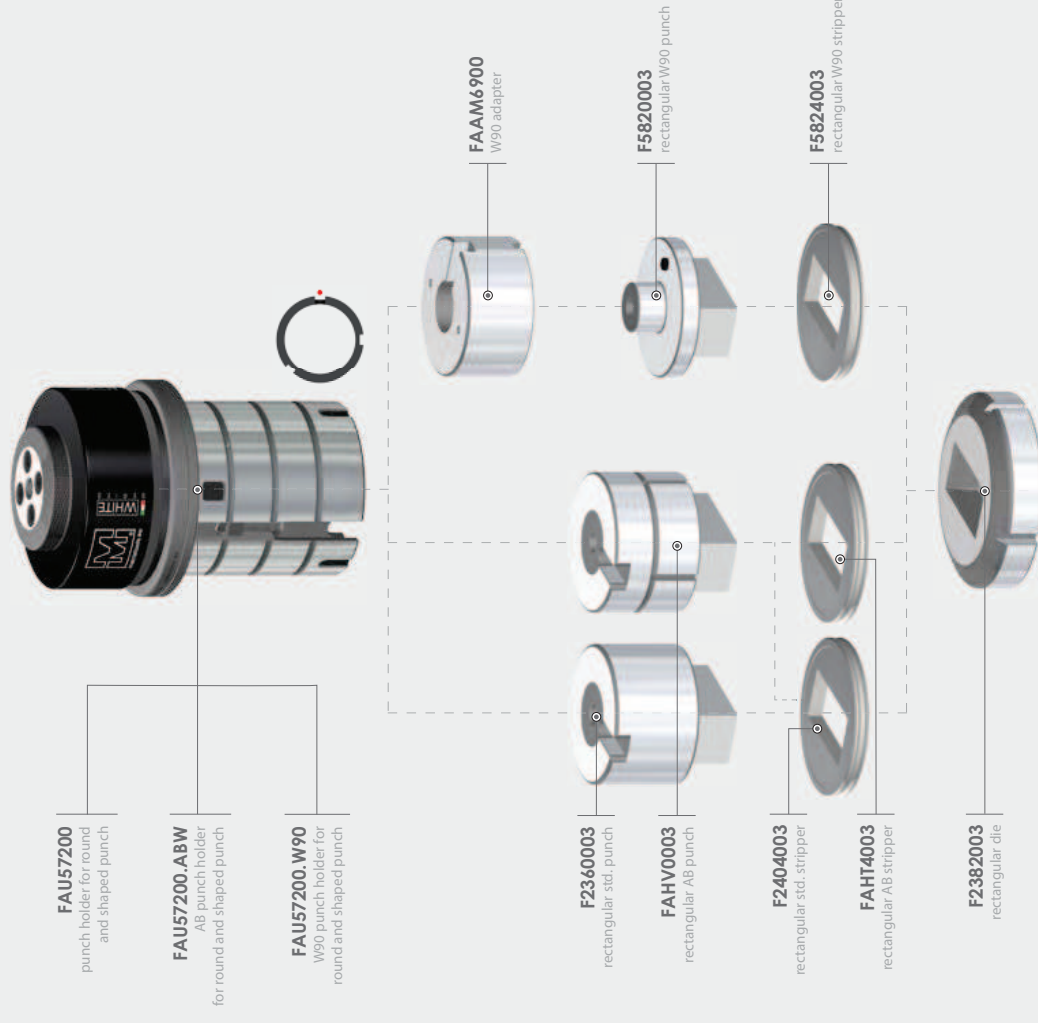

OPTIONS AND NOTES



WHITE SERIES - E STATION - MAX Ø = mm 114,3

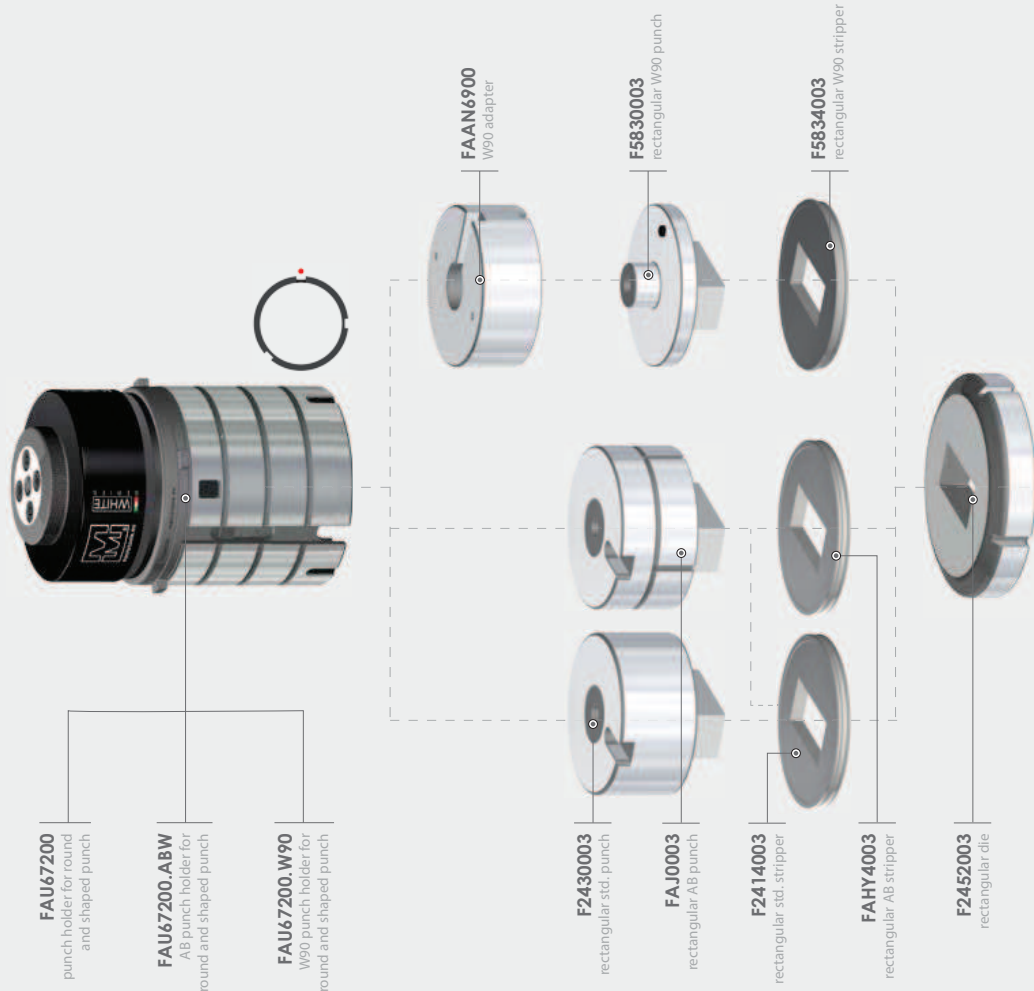

OPTIONS AND NOTES



WHITE SERIES - F STATION - MAX Ø = mm 153,5

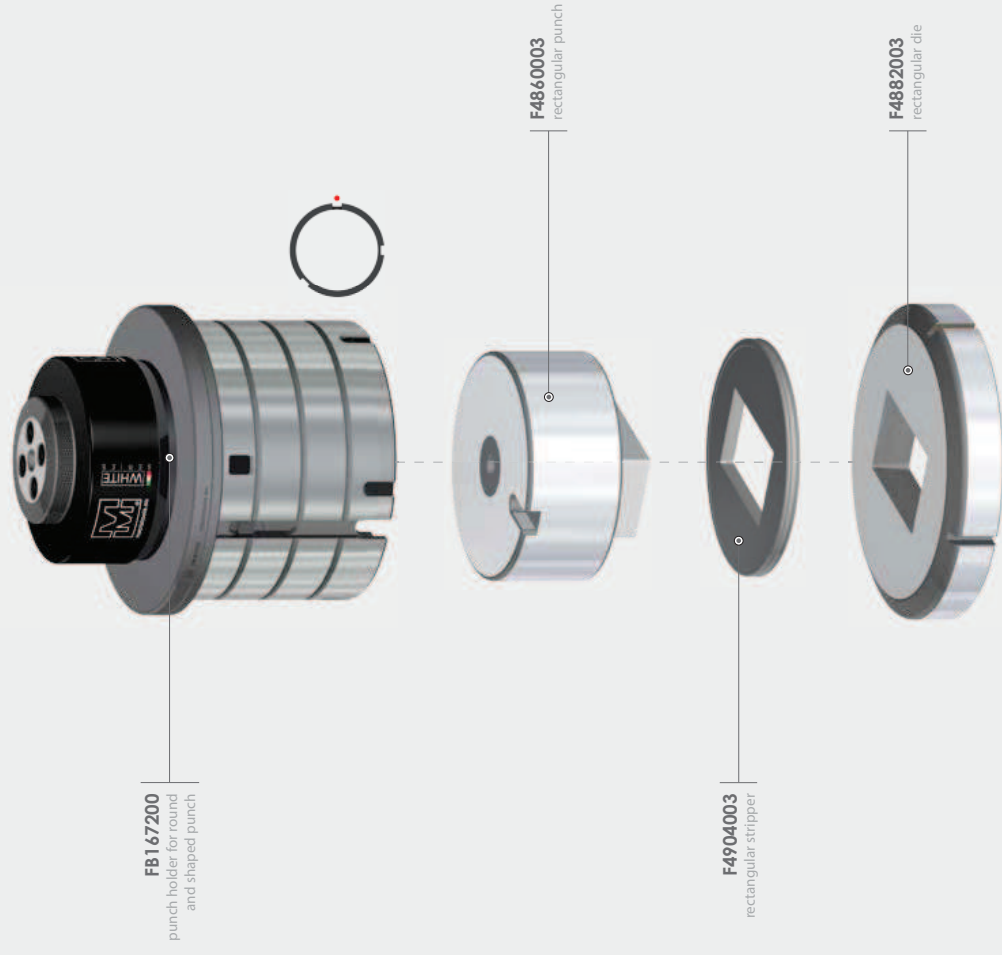

OPTIONS AND NOTES



RED SERIES - C STATION - MAX Ø = mm 50,8



FAZ17200
punch holder for round
and shaped punch

FAZ17200.ABW
AB punch holder for
round and shaped punch

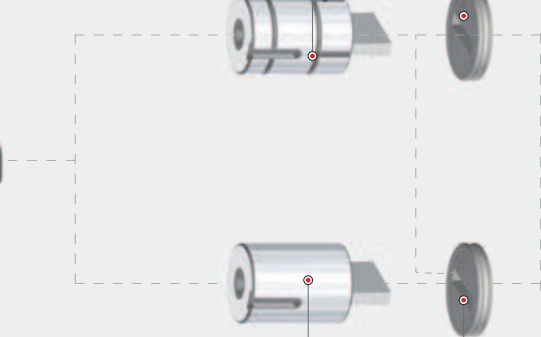

F2290003
rectangular std. punch

FAHQ0003
rectangular AB punch

F2334003
rectangular std. stripper

FAHN4003
rectangular AB stripper

F2312003
rectangular die

RED SERIES - D STATION - MAX Ø = mm 88,9



FAZU7200
punch holder for round
and shaped punch

FAZU7200.ABW
AB punch holder for
round and shaped punch

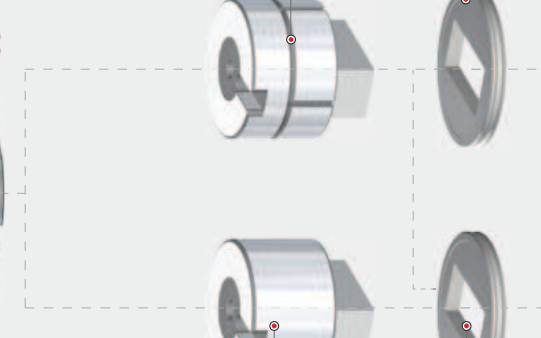

F2360003
rectangular std. punch

FAHV0003
rectangular AB punch

F2404003
rectangular std. stripper

FAHT4003
rectangular AB stripper

F2382003
rectangular die

OPTIONS AND NOTES



OPTIONS AND NOTES

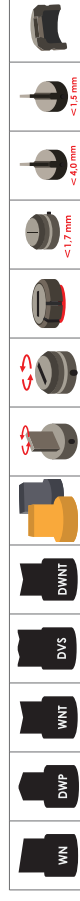

RED SERIES - E STATION - MAX Ø \varnothing = mm 114,3

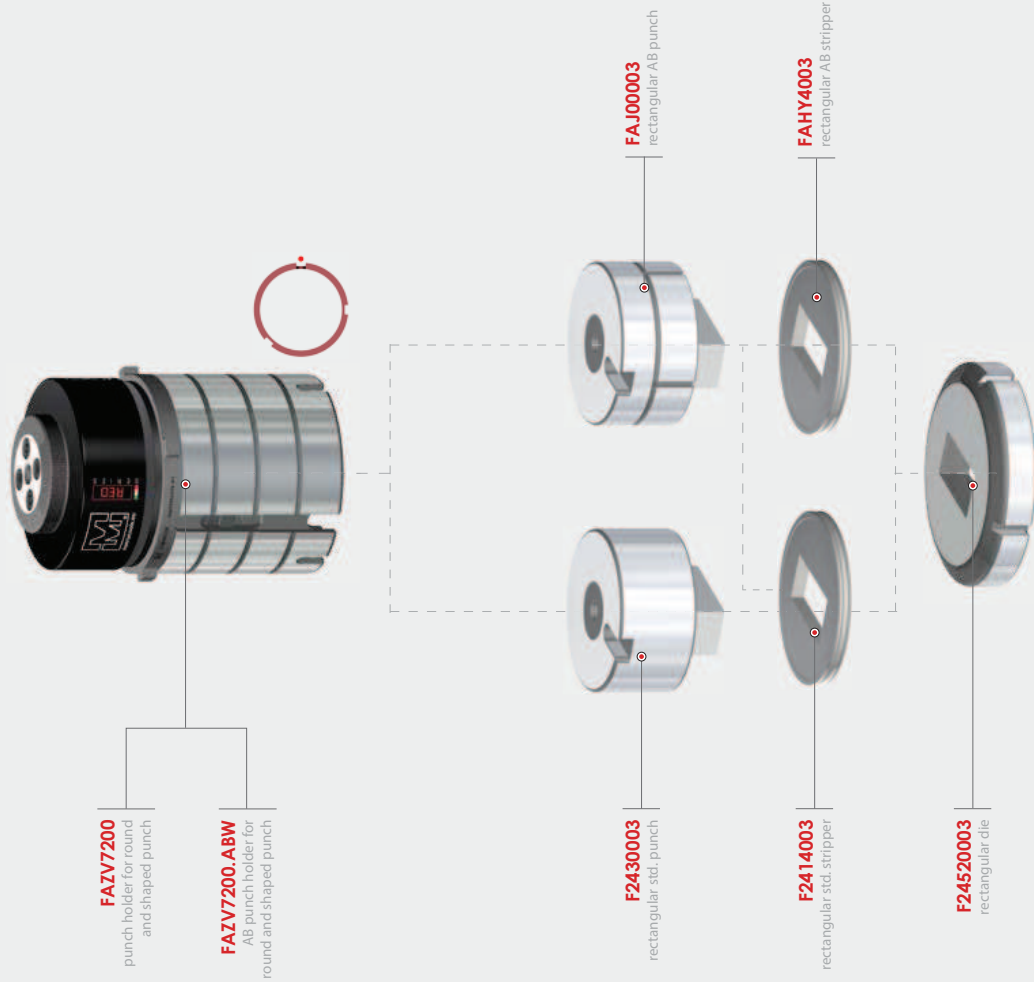

OPTIONS AND NOTES



RED SERIES - F STATION - MAX Ø \varnothing = mm 153,5

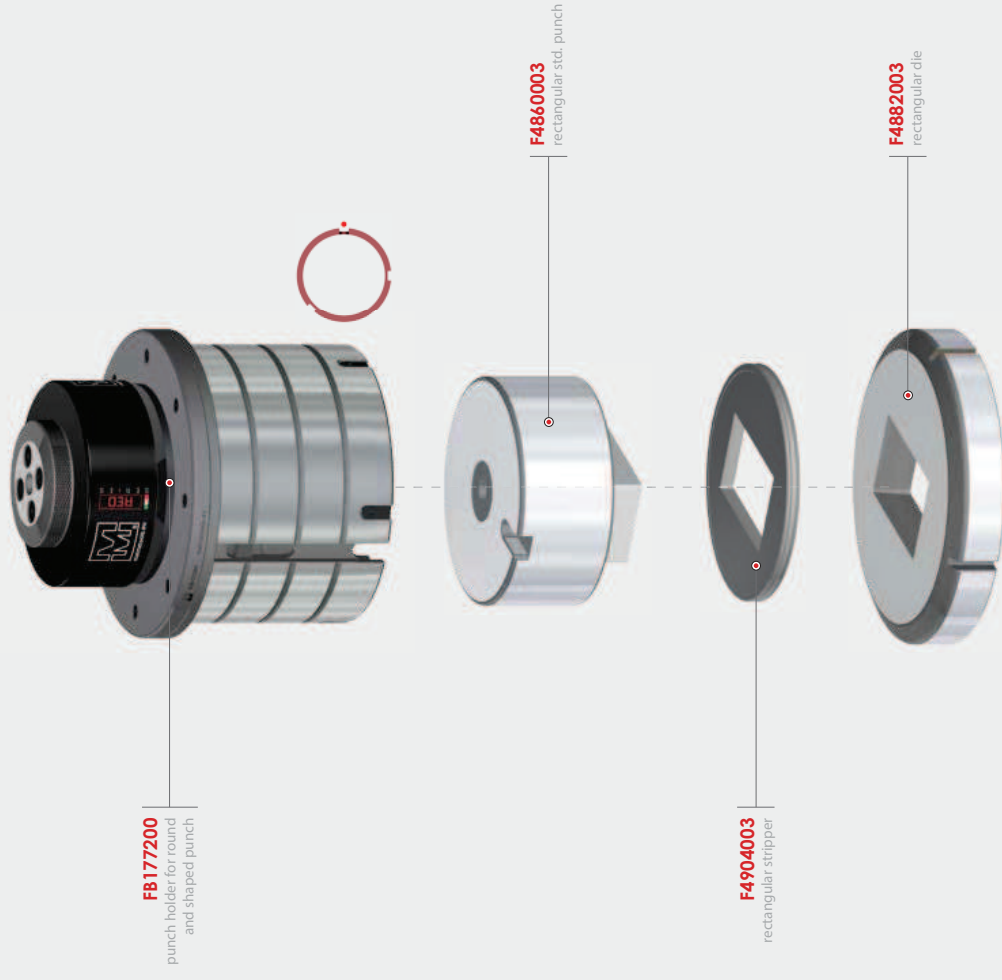

OPTIONS AND NOTES





ACCESSORIES



STANDARD ADAPTORS - thick turret

Essential for monopunch machines, for a better flexibility even on thick turret punching machines. With specific adaptor it is possible to use smaller stations.

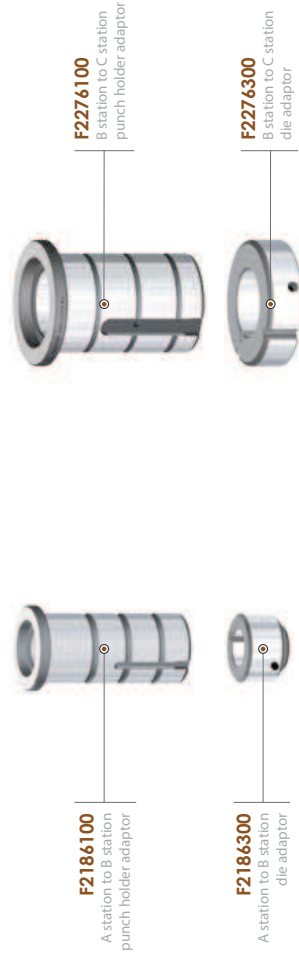

F2186100
A station to B station punch holder adaptor

F2186300
A station to B station die adaptor



F2346100
B station to D station punch holder adaptor

F2346300
B station to D station die adaptor

PARTING TOOLS - thick turret

Simple inserts replacement for an economical solution, preserving the supports elements. Special stripper available as parting insert guide, for wearing reduction and better system rigidity.

C STATION

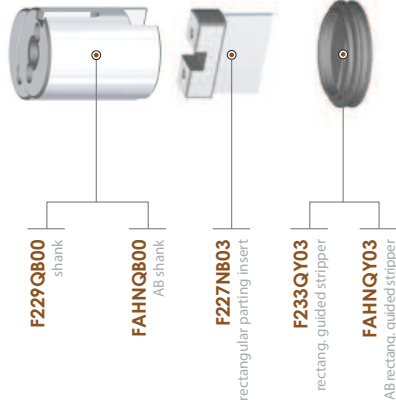

F229QB00
shank

FAHNQB00
AB shank

F227NB03
rectangular parting insert

F233QY03
rectang. guided stripper

FAHNQY03
ABrectang. guided stripper

D STATION

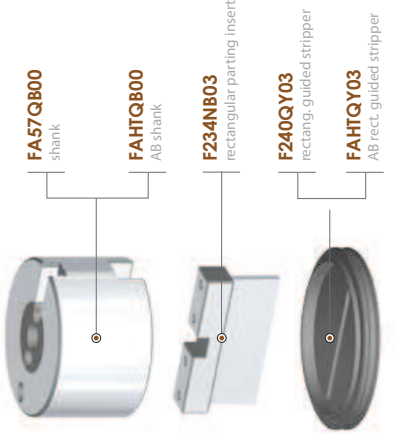

FA57QB00
shank

FAHTQB00
AB shank

F234NB03
rectangular parting insert

F240QY03
rectang. guided stripper

FAHTQY03
ABrect. guided stripper

E STATION

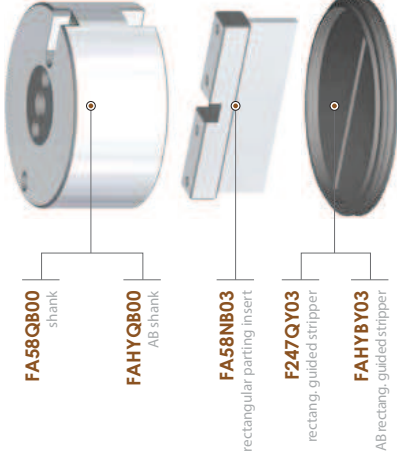

FA58QB00
shank

FAHYQB00
AB shank

FA58NB03
rectangular parting insert

F247QY03
rectang. guided stripper

FAHYBY03
ABrectang. guided stripper



PARTING TOOLS CLOSE TO CLAMP - thick turret D station

Used for cutting metal sheets close to clamps; special stripper as parting insert guide, for wearing reduction and better system rigidity.



PARTING TOOLS CLOSE TO CLAMP - thick turret E station

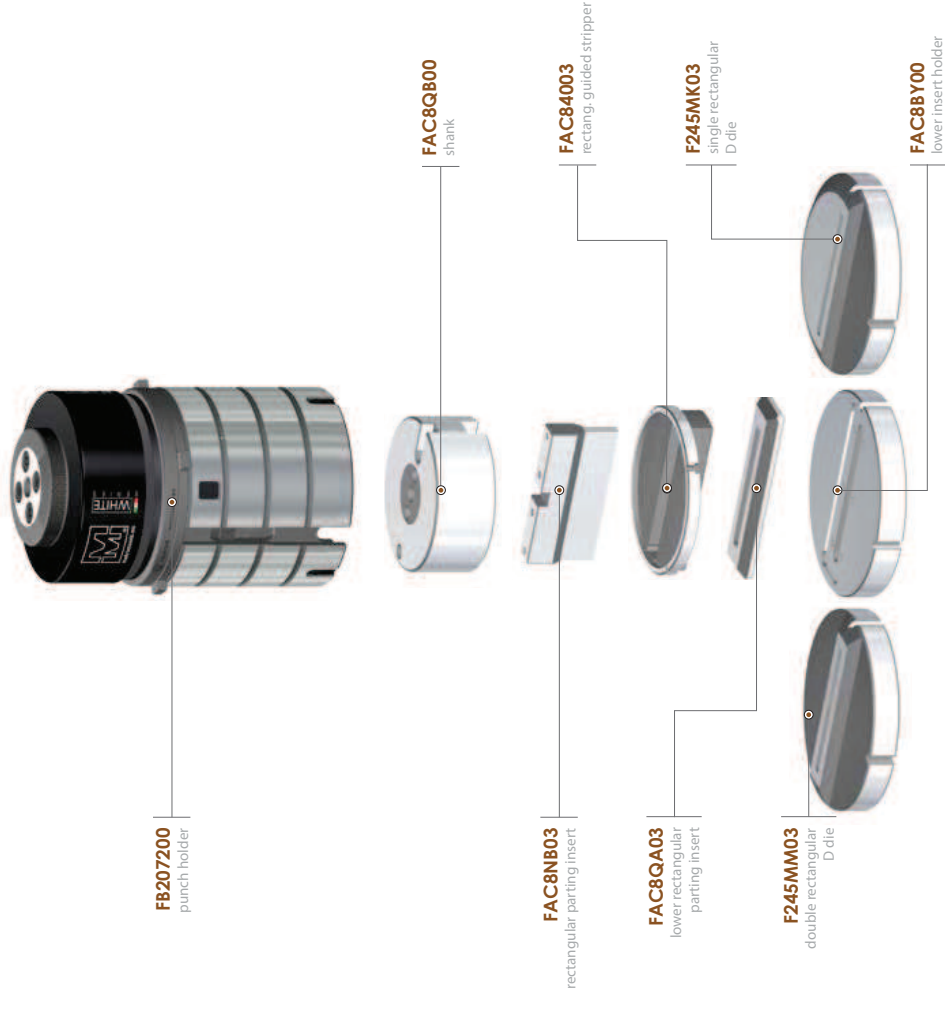

TRUMPF® ADAPTORS - MAX Ø ∅ = mm 76,2

For TrumPF® tools to be used on Thick Turret D station. For standard and sharpened tools, standard strippers. After sharpening, for a longer life the tools height is restored by step adjustment and without modifying the punch press stroke. Quick tools replacement, tools oriented from 0° to 360° with 45° steps. All this, for great performances.

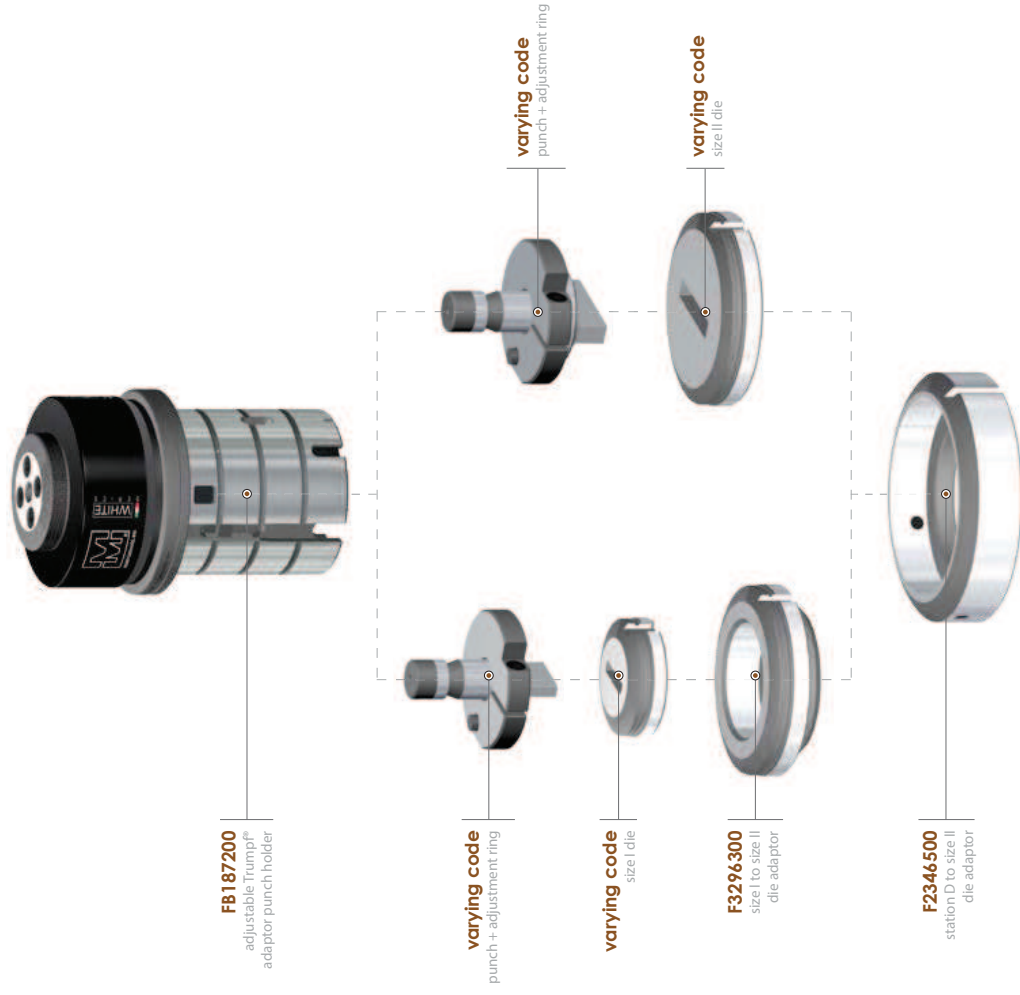

MURATA WIEDEMANN® ADAPTORS - MAX Ø ∅ = mm 76,2

For punches and dies Murata Wiedemann® Series 114 on C and D thick turret stations, either for sharpened or standard tools. Spring assembly for a powerful pulling, improved by a mechanical stripper which replaces the standard polyurethane one. Fast tool interchange, done off the holder, tool orienting from 0° to 360°.



SPECIAL SPRINGS SETS FOR GREEN AND WHITE SERIES

Different types of processing might require particular performances of the punch holders so, because of this, specific springs sets are available to satisfy every need. For punching soft materials such as copper and aluminum it is necessary to reduce the working loading pressure in order to minimize the scratches. It is also recommended to do the same in case of deep punching and/or forming, allowing a stroke increase without risks of springs breakage. There are some heavy processing which require to increase the pulling power. However the different types of springs loading is one of the aspects to be considered. The same interest is given to the speed reaction of the springs, very important aspect in case of high speed processing and nibbling.

By replacing the springs set with one duly dimensioned set, it can be a satisfying solution to the above mentioned situations.

A STATION



B STATION



C STATION

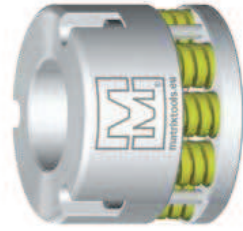

D - E STATION



CENTERING TOOLS A - B - C - D Stations

It requires great care to keep in good condition punch holders and tools as well as a perfect centering of the punching machine. Specific tools for the most common stations, characterized by high precision, for a simple and quick maintenance.

A STATION FACP7800

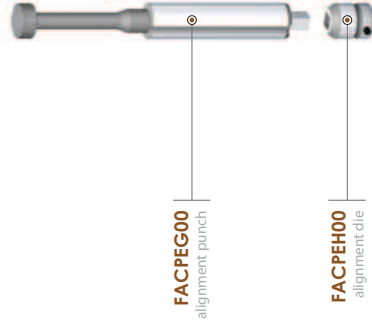

B STATION FAT77800

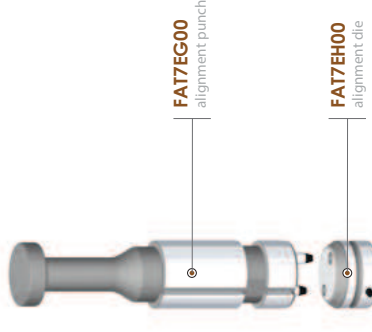

C STATION FAT87800

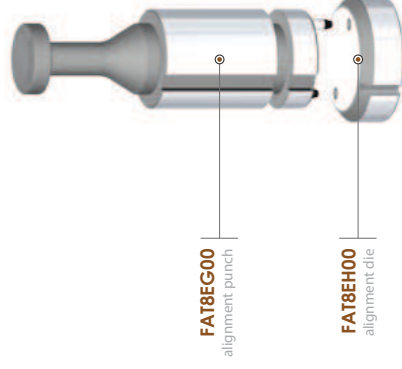

D STATION FAT97800

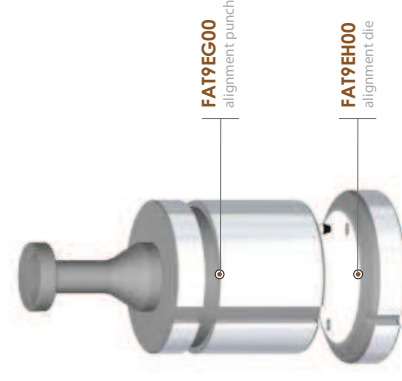

OPTIONS

SURFACE COATINGS (PVD)

In order to improve working characteristics, the surface of all punches can be coated; this treatment gives to the tool surface a considerably greater hardness and self-lubrication. MATRIX uses two types of coating, Type A (Titanium Nitride) and type B (Titanium-Aluminum Nitride).

Type A coating yellow-gold coloured, provides to the punch a higher surface

hardness up to four times the initial one and an optimal self-lubrication capability with a friction coefficient equal to 0.44. It's recommended for exacting working processes, without lubrication or with dough materials difficult to be pulled, such as copper or aluminum alloys.

Type B coating grey-blue coloured, is an evolution of the previous one which, besides

imparting a higher hardness on tool surface, is more solid and its endurance increases; this coating resists to higher temperature, little lower than 900°.

Thanks to these characteristics, it's recommended in case of high speed punching machines (500-1000 strokes per minute) and it's also excellent for STAINLESS STEEL processing.

ANTI SLUG

Slug pulling could get several kind of problems, from the simple downtime to the tools damaging.

For this reason and in order to avoid the problem, our dies, to be used according to specific process, are accordingly designed.

SHEAR SHARPENING

For punch shear sharpening we mean various geometry of their faces which grants several benefits such as:

- Noise Reduction
- Reduction of vibration and counterstrokes of all machine components

- Slug pulling reduction
- Tonnage reduction
- Easy pulling

On the other hand, tools with special shear provides punch holders springs a harder functioning.

Shear types most commonly offered are:

- DVS for shearing tools and high thicknesses
- DWP for balanced loadings and high thicknesses
- DWNT for thin thicknesses - nibbling processes with big shapes
- WNT for thin thicknesses - nibbling processes with small shapes
- WN for thin thicknesses - nibbling processes with small shapes



MAX DIAGONALS THICK TURRET TOOLS

A Station	B Station	C Station	D Station	E Station	F Station
mm 12.7	mm 31.7	mm 50.8	mm 88.9	mm 114.3	mm 153.5

Material thickness in mm	1	1,5	2	2,5	3	4	5	6
Tonnage reduction in %	60	50	40	35	25	20	15	10

PUNCH GRINDING EFFECTS ON TONNAGE

Find here below an illustrative table concerning tonnage reduction, considering DWP shear with standard depth.

TONNAGE GENERAL FORMULA

	Material	K material
$P \times S \times K = 28,3$	Aluminum	0.6
	Copper	0.6
	Brass	0.6
	Mild steel	1
	Stainless steel	1.5

Example: 40 (square perimeter of mm 10 edge) $\times 2$ (material thickness in mm) $\times 1,5$ (K stainless steel) = **4,24** (tonnage) **28,3**

DIES TOLERANCE IN PERCENTAGE TO THICKNESS

Material	Thickness Range	Minimum or Blanking*	Standard	Maximum
Aluminum	Up to mm 2	8%	10%	12%
	From mm 2 to mm 4	10%	12%	15%
	Over mm 4	12%	15%	20%
Mild steel	Up to mm 2,5	15%	18%	20%
	From mm 2,5 to mm 5	18%	22%	25%
	Over mm 5	20%	25%	30%
Stainless steel	Up to mm 1,5	15%	20%	22%
	From mm 1,5 to mm 3	18%	22%	25%
	Over mm 3	20%	25%	28%

* Blanking: when the scrap is the requested part.

LUBRICATION: A MUST

It's the first rule to apply: being punching a shearing and extrusion process, in order to get a good result, lubrication of the shearing area is a must.

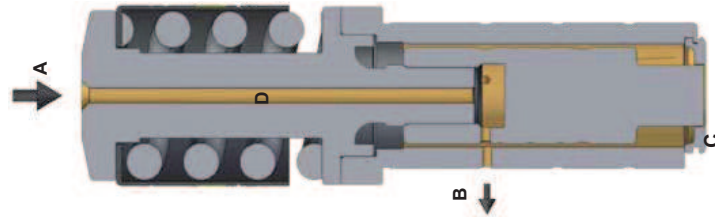

Lubrication has an essential role on punching machines, particularly on punching stamps. During punching phases, small quantities of material get stuck to the punch surface. A lubricant oil with proper characteristics acts as a barrier between punch and material reducing significantly both friction and material build up on the punch surface, improving therefore the punch life.

If for some reasons lubrication is a problem, Titanium coated punches could help. On machines without an automatic lubricating system please daily fill up the central bore with sliding oil and always to each equipping. When you fit a punch on the punch holder we recommend to lightly oil the punch body with graphite grease. Inobservance of this rule will cause an excessive punch holders wearing.

With the schema on the left, valid for A and B stations, you can see the course of the lubricant.

The letters respectively indicate:

- A** Bore for lubricant liquid
- B** Bore to let the lubricant liquid into the outer punch holder walls and its housing contact area
- C** The oil, by lubricating the punch cutting part, improves shearing and pulling
- D** Tank for lubricant

Matrix can supply lubricant and shearing oils for different working requirements. Evaporable oils are also available whenever grease waste parts must be avoided.

GRINDING: THE IMPORTANCE OF MAINTENANCE

Professional grinding and maintenance grant more lasting and constant performances on punching tools.

All this can be done by the punching machine operators with grinding machines and accessories for an easier, quick and economic operation.

Matrix can satisfy any customers with these specific needs thanks to our machine range, accessories, lubricants and instructions. Specific documentation available on demand.



JETFORM



JETFORM - GREEN SERIES - ADJUSTABLE HEIGHT

B STATION

MAX Ø \varnothing = mm 25

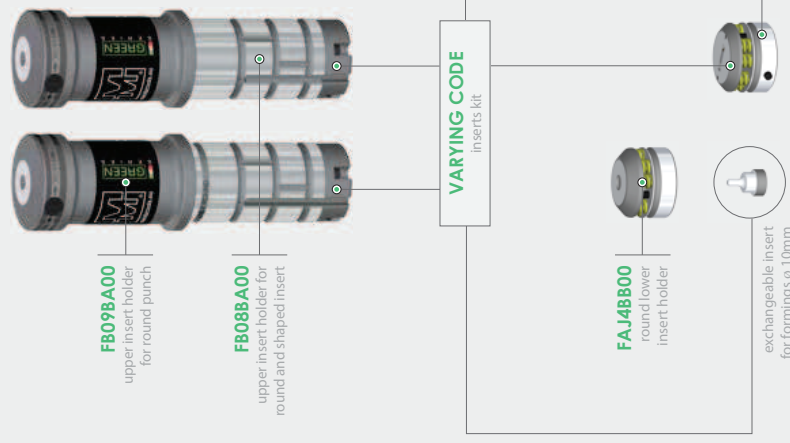

C STATION

MAX Ø \varnothing = mm 40

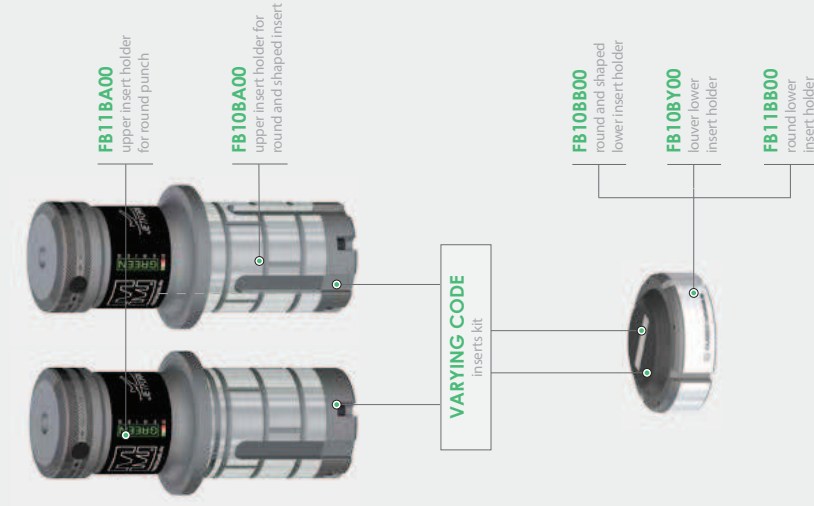

D STATION

MAX Ø \varnothing = mm 70

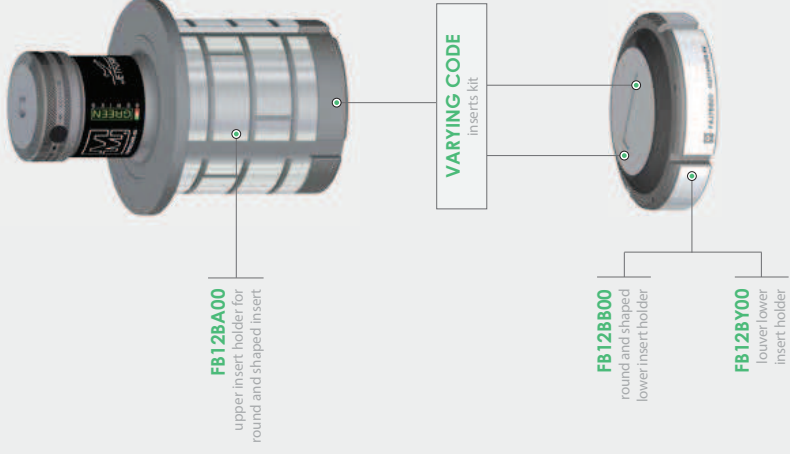

E STATION

MAX Ø \varnothing = mm 105

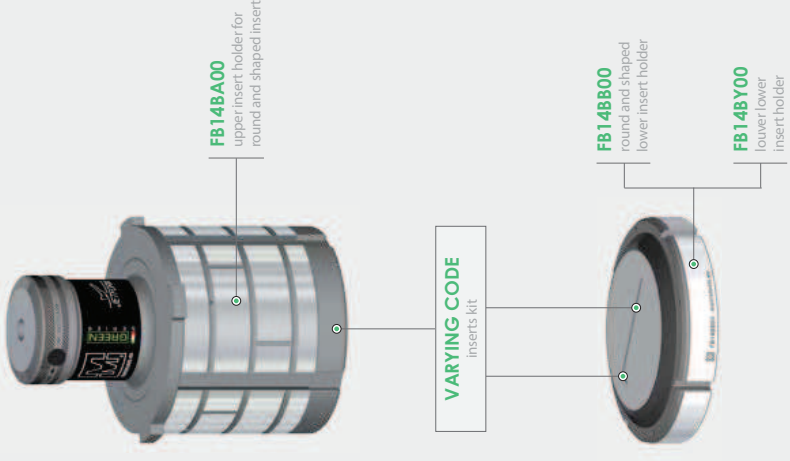

Accurate tool height adjusting by mean of 0.08 mm steps which characterize Green Series punch holders, for the maximum performances on punching machines with imprecise or without stroke adjusting.

Tools for the most common formings are available for a quick delivery.
Our sales department is at your complete disposal to provide you with updated list.

JETFORM - WHITE SERIES

B STATION MAX Ø = mm 25



FAZFBA00
upper insert holder
for round insert

FB24BA00
upper insert holder for
round and shaped insert

VARYING CODE
inserts kit



FAJ4BB00
round lower
insert holder



exchangeable insert
for formings ø 10mm

C STATION MAX Ø = mm 40

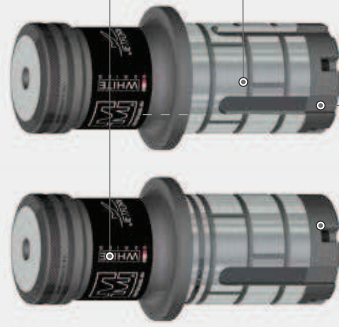

FAZGBA00
upper insert holder
for round insert

FAQ9BA00
upper insert holder for
round and shaped insert

VARYING CODE
inserts kit

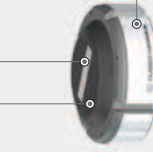

FB10BB00
round and shaped
lower insert holder



FB10BY00
lower lower
insert holder

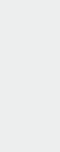

FB11BB00
round lower
insert holder

D STATION MAX Ø = mm 70

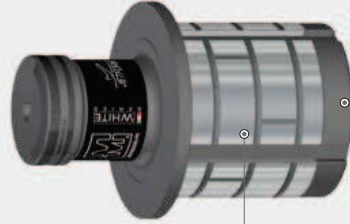

FAR0BA00
upper insert holder for
round and shaped insert

VARYING CODE
inserts kit

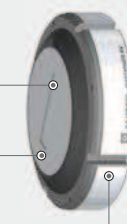

FB12BB00
round and shaped
lower insert holder

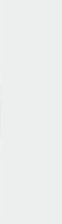

FB12BY00
lower lower
insert holder

E STATION MAX Ø = mm 105

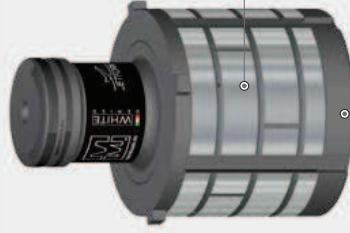

FAR1BA00
upper insert holder for
round and shaped insert

VARYING CODE
inserts kit



FB14BB00
round and shaped
lower insert holder

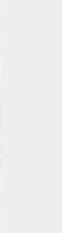

FB14BY00
lower lower
insert holder

White Series punch holders, for extremely advantageous forming processes on punching machines recently manufactured, taking advantage from the stroke adjusting.

Tools for the most common formings are available for a quick delivery. Our sales department is at your complete disposal to provide you with updated list.

Lined writing area with horizontal lines.



MATRIX

Via Ponte d'Oro, 8 • 36015 • Schio • Vicenza • Italy
T. +39 0445 67.10.15 • F. +39 0445 67.10.35
www.matrixtools.eu • sales@matrixtools.eu